

1. BATTERY INSTALLATION AND CHARGING

(1) If it's powered by AAA batteries, please install as shown below:

First Use: Remove the insulation sheet before using (Note: if the battery is included).

Change battery: Open the battery cover, take out the used batteries, then install the new ones properly as directed shown below.

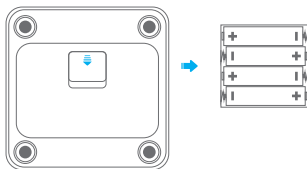

Note:
Please use the right battery. Remove battery if the scale leaves unused for more than 3 months

(2) If the scale is with built-in rechargeable battery

1. The scale should be fully charged when firstly used or after long-time stored. Battery symbol flashes during charging and displays constantly when charging is finished. It takes about 2 hours to finish.
2. Please use android 5V charger with current equal to or smaller than 2A. DO NOT use charger with voltage larger than 5V.
3. Suggest to charge every 3 months if the scale leaves unused for a long time.



Note:
Battery symbol is shown on LCD during charging. For your safety, please do not use the scale during charging. Only start weighing after charging is finished and removing charger.

2. DOWNLOAD AND SET UP THE APPLICATION

Search "MovingLife" in "App Store" or "Google Play" to download the Application. Or in another most convenient way by scanning the QR code below.



Tips: App is kept updating, so it may differ from showed on manual. For the final and accurate information, please check on App.

3. CONNECTING AND REGISTERING

Open APP "MovingLife", connect the scale with App. Submit your personal profile as directed on the App.

Tips: Before connection, please make sure the Bluetooth on the smart device is on, and the scale is also turned on; In order to ensure the measuring accuracy, please make sure the personal profile you submitted is correct.

The display is lighted up

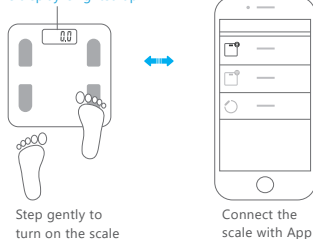

4. MEASURING

Place the scale on hard and flat floor. Stand on the scale with bare feet. When the weight and measuring data are stable and flashing, the data will be transmitted to the smart device. After transmitting is finished, the scale will show the weight and measuring data for seconds before auto off.



Place the scale on hard and flat floor.

Keep your bare feet on the electrodes of scale.

Check the measurement data on App.

Tips:

- To make a proper measurement, please keep your bare feet on the electrodes of scale until the measuring is finished.
- If the product is with heart rate function, please wait until heart rate measuring is finished. The whole process will take about 20 seconds.
- If the APP is not connected for the first time of measuring, only weight can be measured, but no body fat. Please connect the APP before using.

5. MULTIPLE USERS SUPPORTED

Multiple users blinding in one scale is supportable. Maximum 15 groups history data of each user can be stored. Data will be automatically synchronized to the smart device when APP is running.

Tips: Final user amount depends on the product.

6. DISPLAY ICONS



Measuring is in process, please do not step off the scale, and keep your bare feet on the electrodes of scale



Re-measuring needed
Error exists, please measure again.



Over-load Indication
The weighing subject on the platform exceeds the maximum capability of scale. Please step off to avoid damage.



Low Battery Indication
The battery power is running low, please replace with new batteries.

7. ABOUT THE UNIT

- It is suggested to set the unit on App.
- Or you can change the unit by the UNIT switch button on bottom of the scale (If the scale is with such button).
- The factory unit setting differs from different sales destination. Please refer to the actual product.
- Product with rechargeable battery is with a restart button as shown in the picture. If the product cannot work properly, please press the restart button to reset the scale with the aid of a sharp object.

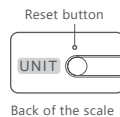

Back of the scale

8. ADVICE FOR USE & CARE

1. To ensure the accuracy of the data, it is recommended that each measurement be carried out at the same time of day. Don't use in strong electro-magnetic condition and field with intense shake .
2. If the scale leaves unused for long time, when first weighing, please tap on the scale to make display show zero and let the scale be off automatically. Then you can tap on again to start weighing.
3. Stand on the scale steadily and touch the electrodes on the platform with your bare feet. Tip over will lead to a fall when you step on the edge of one side of the scale. Keep standing firmly on scale when in use.
4. Since the scale surface is smooth, please do not use the scale on slippery floor or stand on the edge of the scale; Always stand onto the central part of the scale and adjust your feet to touch the 4 electrodes after you stand stably. Please keep standing firmly and balanced to prevent sliding.
5. Measuring results will be not accurate after strong exercises, overeating or in seriously dehydrated status.
6. Regarding the body composition analyzing, the measuring data may be not accurate for the below users:
 - Children under 18 or adults over 70
 - Professional sporters such as body builder

7. Below people are not suggested to use this product:
 - Pregnant women, Artificial dialysis patients, Bloated body status
 - People who are with heart pacemakers or other medical instruments inside the body are forbidden to use this product
8. When the batteries run out, please remove the batteries in time to prevent leakage of the battery lead scale body corrosion;
9. Do not drop, shock or strike the scale as it is a precise instrument.
10. Keep the scale clean. Do not use acid cleaning agent.

BRIEF INTRODUCTION

This scale can transmit your body composition data to smart device via Bluetooth technology. It can graph your weight and other data, from which you are able to keep track of the trend anytime. Download the App to your smart device, and start the control to your weight and body shape.

USER-FRIENDLY TIPS

The body composition data are for reference purpose. Should not be used for medical treatment and can not be used in any medical institution.

Growing children, pregnant women, those with symptom of edema or, on heart bypass treatment are not suggested to use the product

FAQ

The software can't obtain weighing results from Smart scale.

- Please confirm the connection sign on the App interface to know the connection status.
- Confirm the Bluetooth is on in your device and the Smart scale is on within the valid range of signal coverage.
- Check whether the battery power is running low, please replace with a new battery.
- Relaunch the application.
- Turn off the Bluetooth and on again, then bridge the Bluetooth connection between scale and smart phone again.

Fail to connect to your device

- Please make sure only one device is setting up connection with the Smart scale.
- Please make sure your device is equipped with Bluetooth 4.0 or above.

LCD has no response

- Please first check the batteries and replace them if necessary
- Repairs may only be carried out by our authorized customer service or dealers.

AMILA[®]
SMART
FITBODY5



Distributed by **ELDICO SPORT SA**
eMail: support@eldico.gr • Web Site: eldico.gr

