

## PORTABLE BASKETBALL HOOP MANUAL



Please identify parts and read this manual carefully before installation.  
We're looking forward to hearing from you on any warranty queries or suggestions!

# **SAFETY INSTRUCTIONS**

**FAILURE TO FOLLOW THESE SAFETY INSTRUCTIONS MAY RESULT IN SERIOUS INJURY OR PROPERTY DAMAGE AND WILL VOID WARRANTY.**

**Do not stand the basketball hoop upright until the base is filled with water or sand, as system may tip over causing injuries.**

**Do not use system during windy and/or severe weather conditions the basketball hoop is easy to tip over, please move the system indoors.**

**Must tip the system forward and rest the rim on a surface before adjusting the height.**

- Owner must ensure that all players know and follow these rules for safe operation of the system.
- Check entire box and inside all packing material for parts and additional instruction material.
- Before beginning assembly, read the instructions and identify parts according to this manual.
- Proper and complete assembly, use, and supervision are essential for proper operation and to reduce the risk of accident or injury.
- A high probability of serious injury exists if this system is not installed, maintained, and operated properly.

- Two capable adults are recommended for this operation.
- Check base regularly for leakage. Slow leaks could cause system to tip over unexpectedly.
- Seat the pole sections properly(if applicable). Failure to do so could allow the pole sections to separate during play and transport of the system.
- Climate, corrosion, or misuse could result in system failure.
- This equipment is intended for home recreational use only and not excessive competitive play.
- The life of your basketball pole depends on many conditions. The climate, placement of the pole, Location of the pole, exposure to corrosives such as pesticides, herbicides, or salts are all important.
- If technical assistance is required, contact Customer Service.

**Most injuries are caused by misuse and not following instructions. Use caution when using this system.**

# GET TO KNOW THE BASIC PARTS

## BACKBOARD

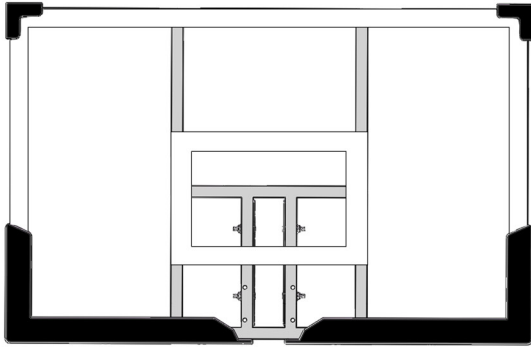

1

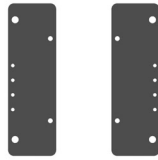

2

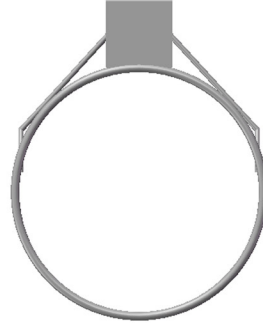

3

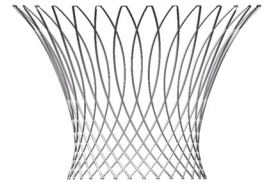

4

## BASE

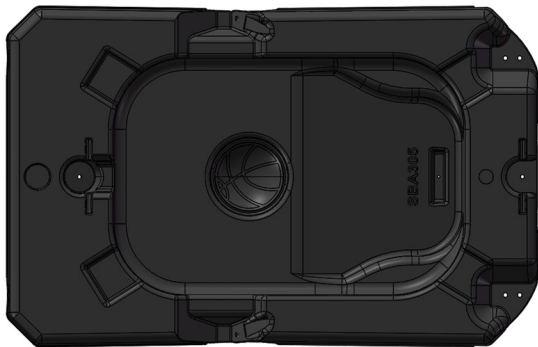

5

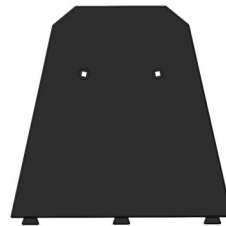

7

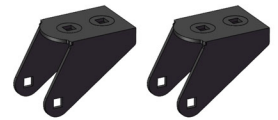

10



6



8

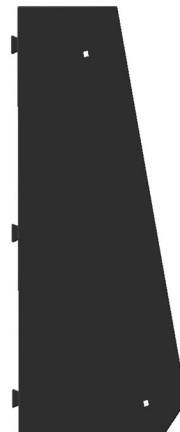

9



11



12

# GET TO KNOW THE BASIC PARTS

## SUPPORT POLE



W



X



Y



small hole

13

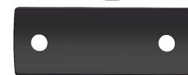

big hole

14

## SPARE PARTS



M8 x 25mm

15



M8 x 35mm

16



M8 x 30mm

17



M8 x 40mm

18



M8 x 45mm

19

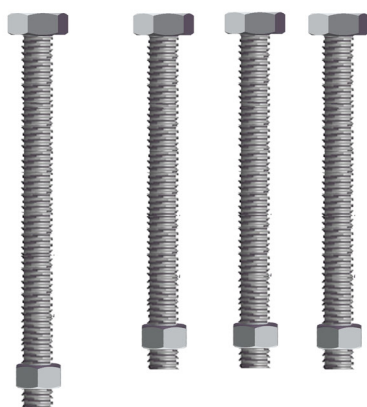

M8 x 90mm

27



M8 x 50mm

20



M8 x 55mm

21

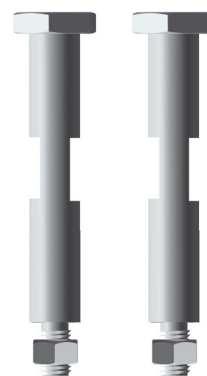

13 x 66.5mm

23



13 x 64.5mm

24

M8 x 80mm

28

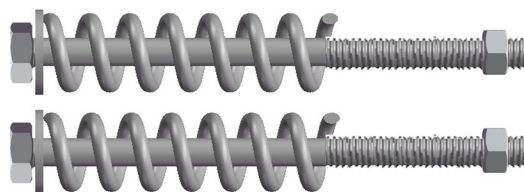

M8 x 120mm

22



Base Cover

25



26



# GET TO KNOW THE BASIC PARTS

## TOP SUPPORT POLE

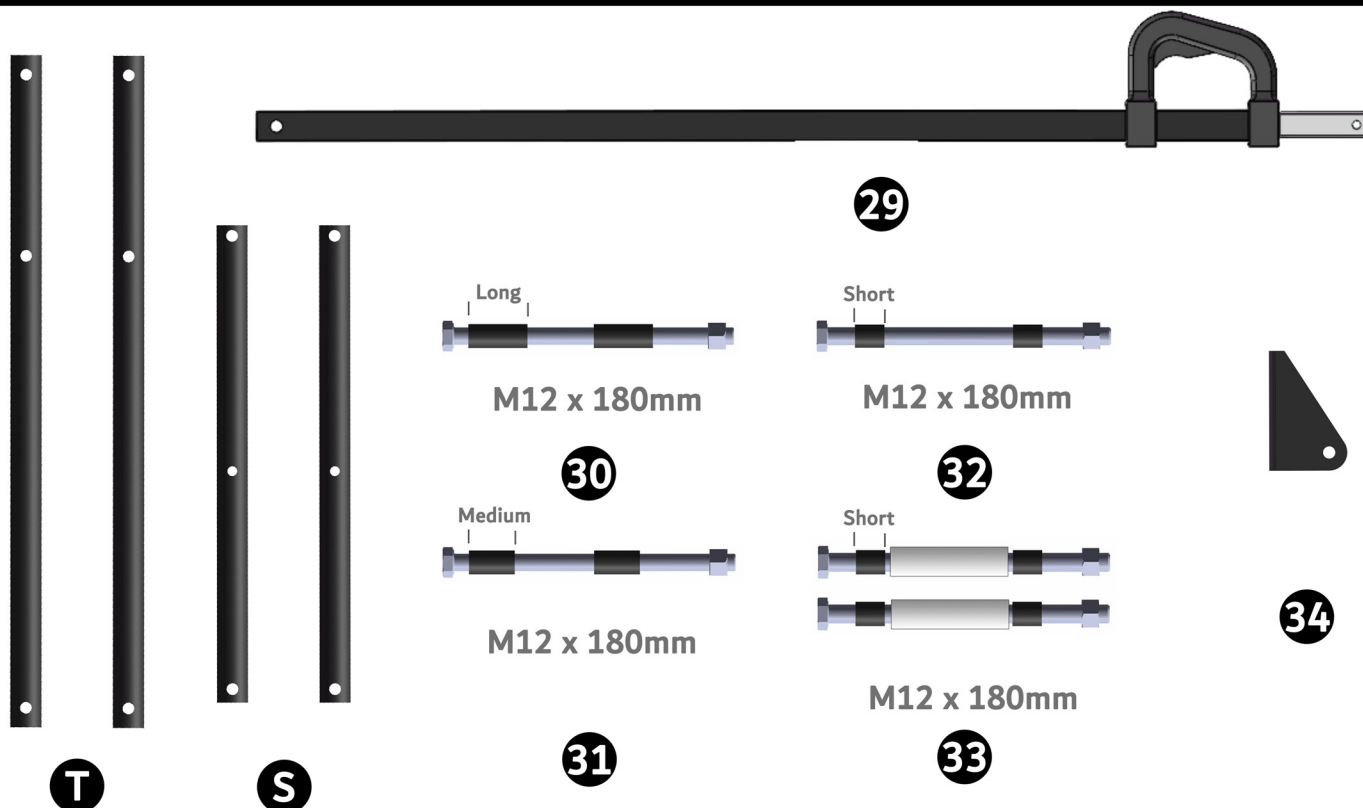

## NOTE

Before you start installing the basketball hoop, Please check if the number of parts is the same as the parts list in this manual, If you find some parts are missing, please contact WIN.MAX customer service, we will provide you with new parts for free.

## TOOLS NEEDED



# INSTALLATION STEPS

## BACKBOARD

### Needed Parts

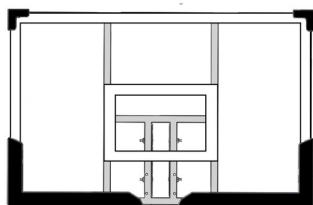

1



2



3



16



20

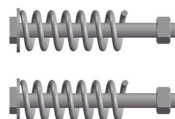

22

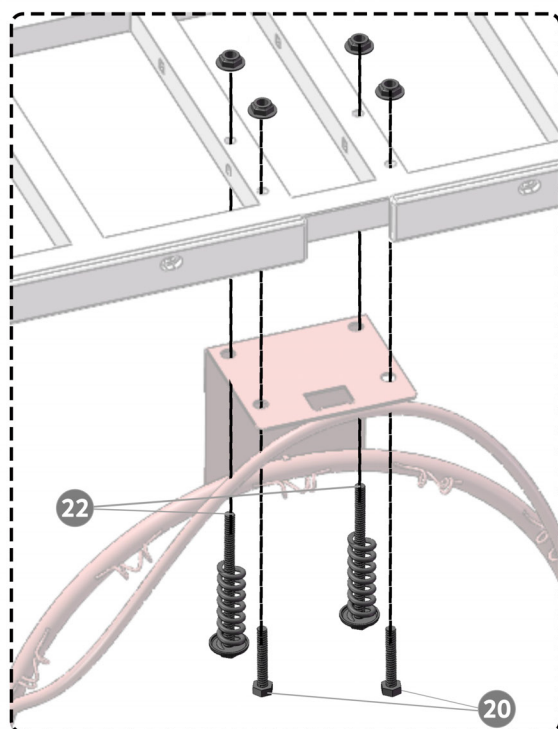

1.1

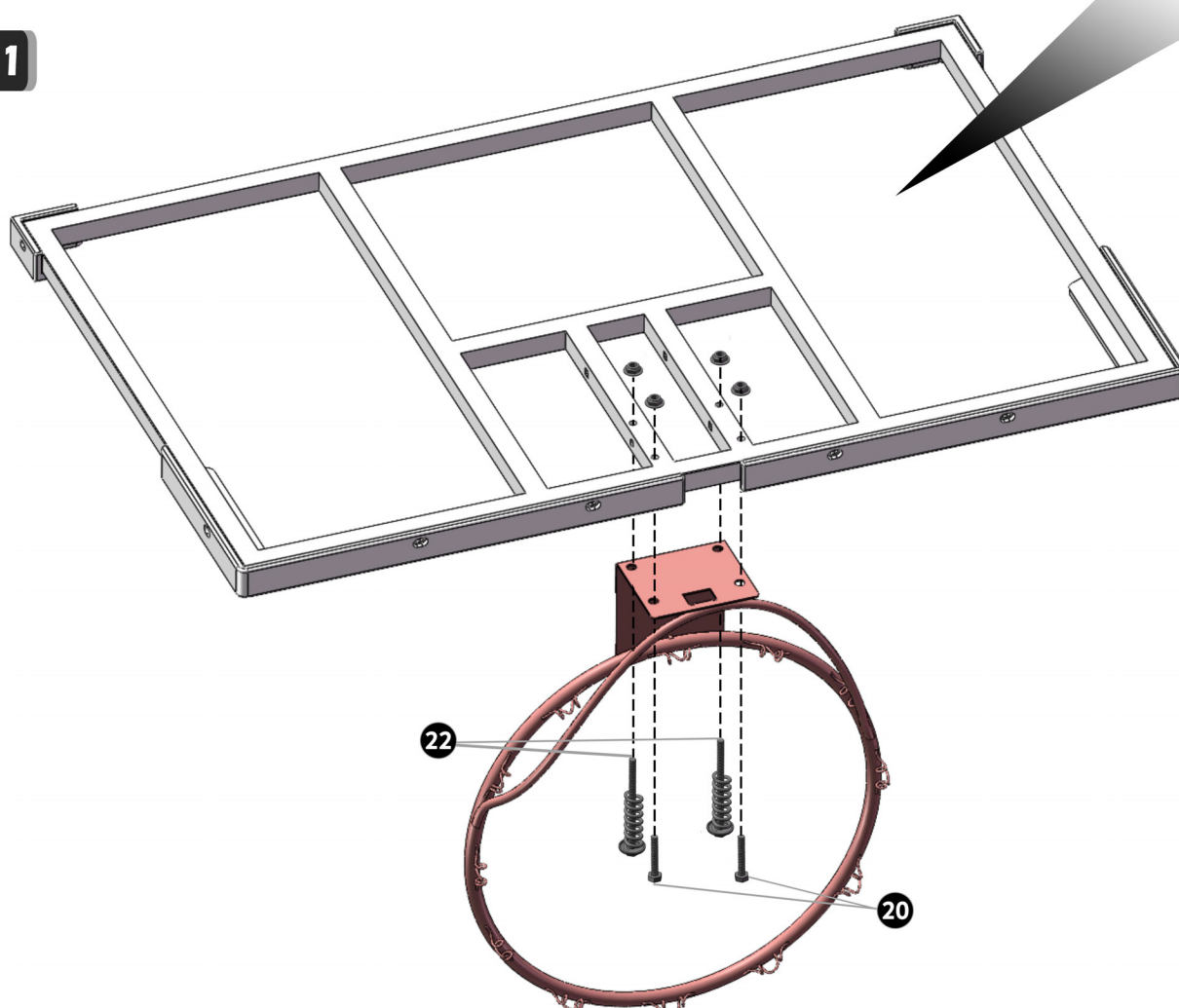

# INSTALLATION STEPS

## BACKBOARD

1.2

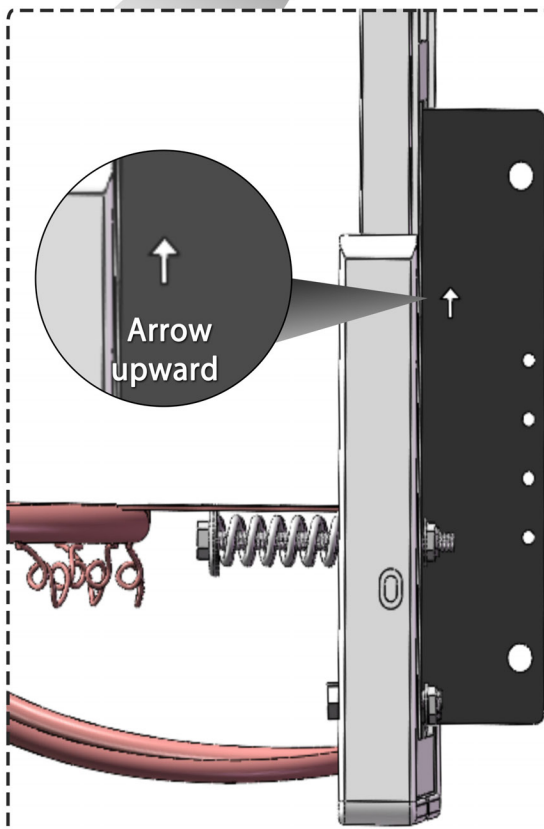
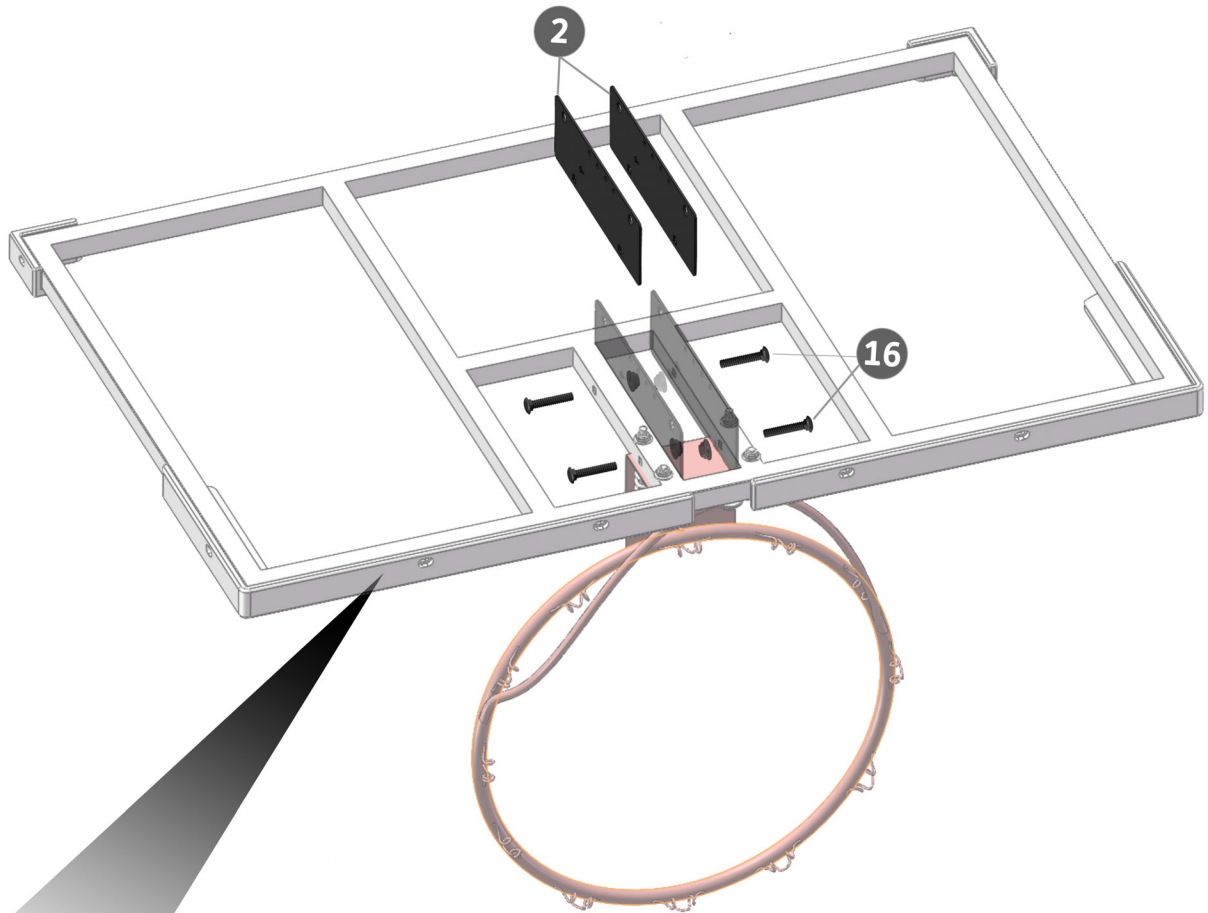

Install the iron sheet  
inside the frame

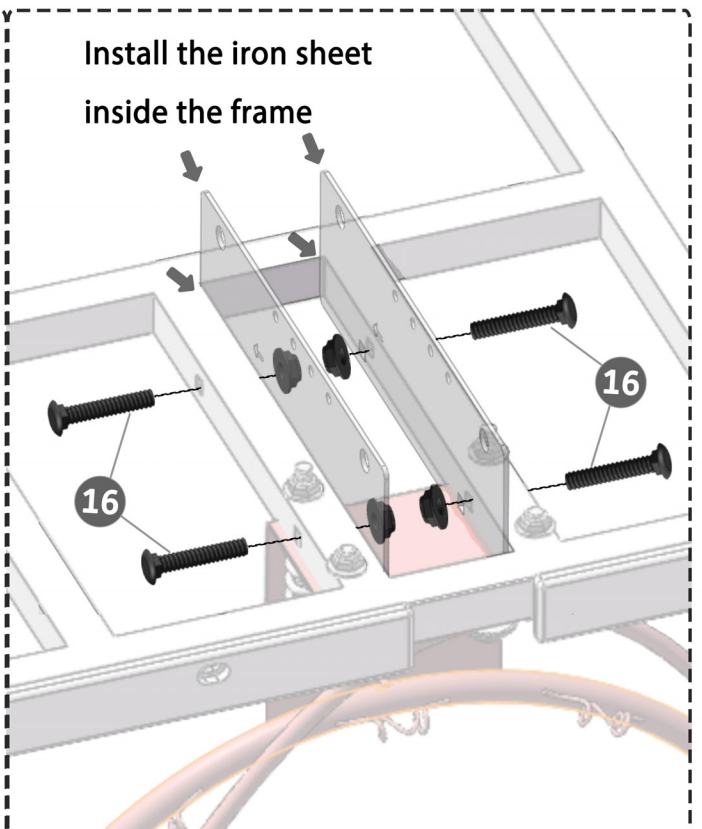

# INSTALLATION STEPS

## BACKBOARD

2.1

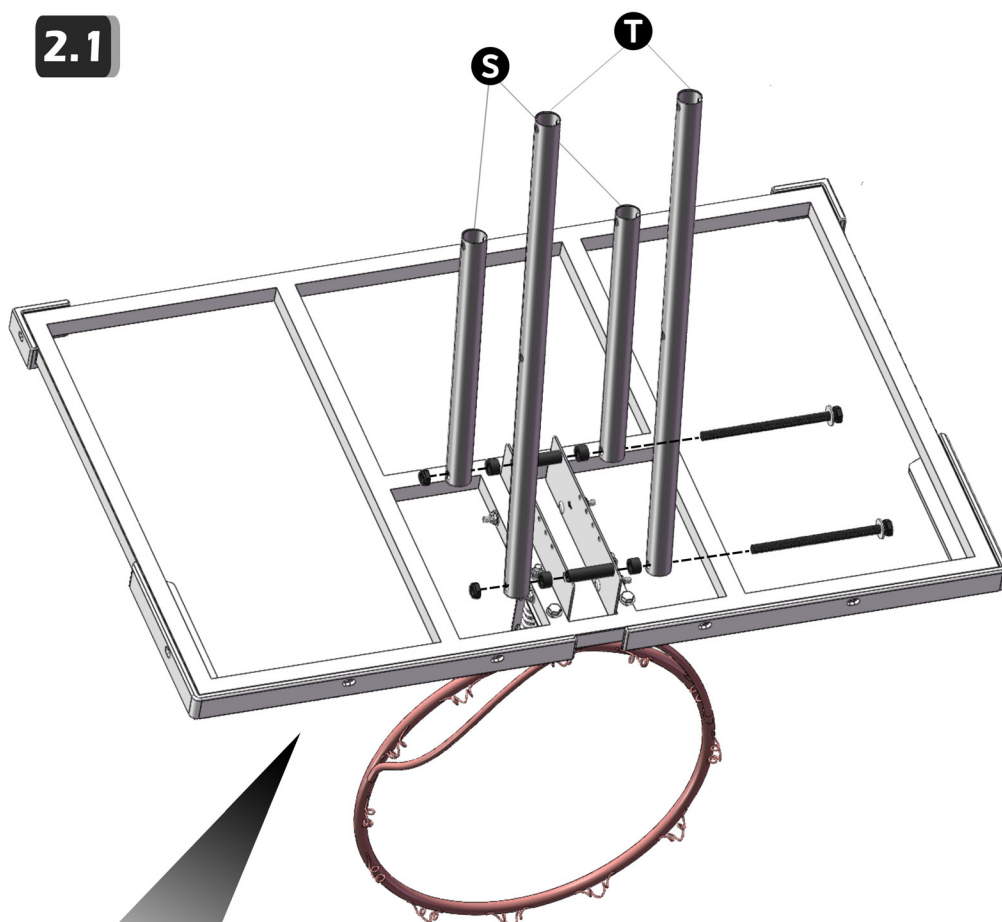

### Needed Parts

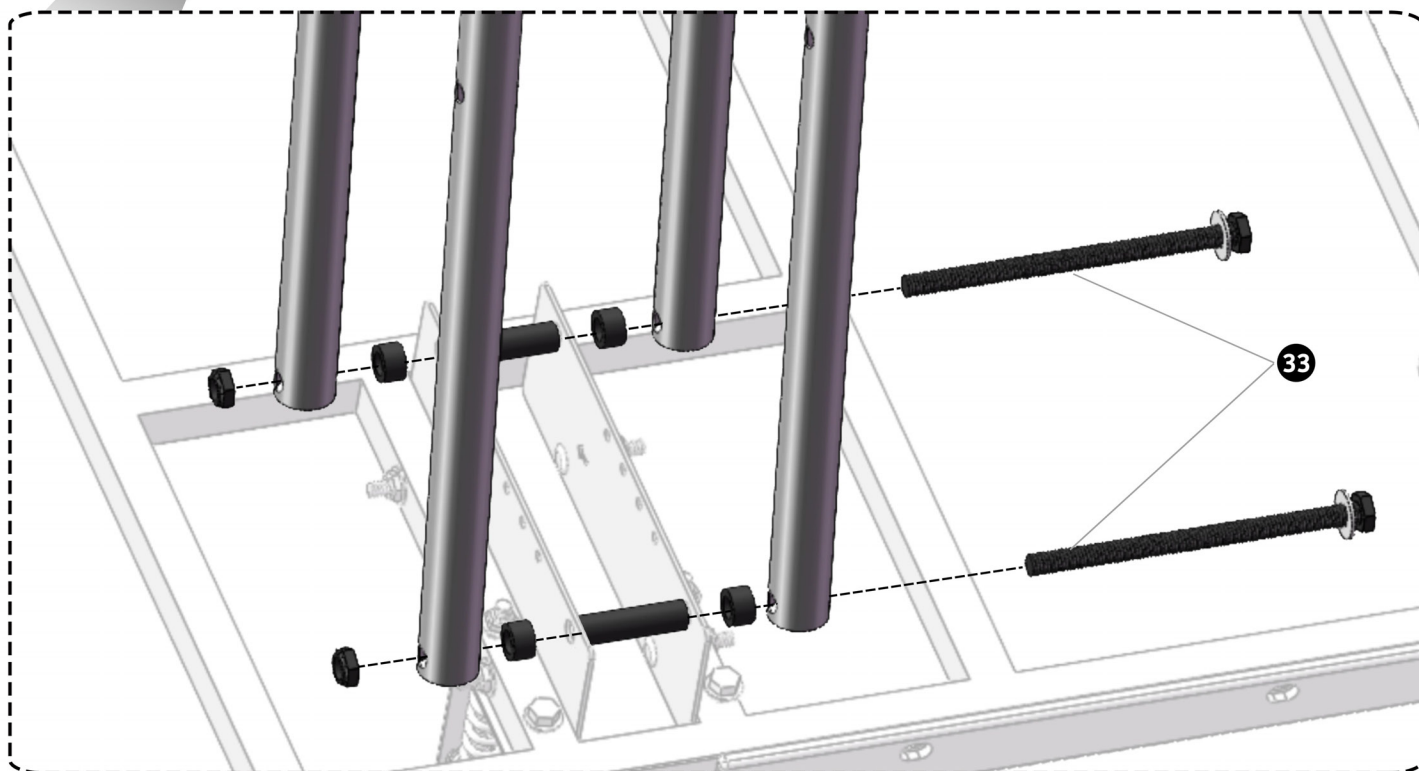
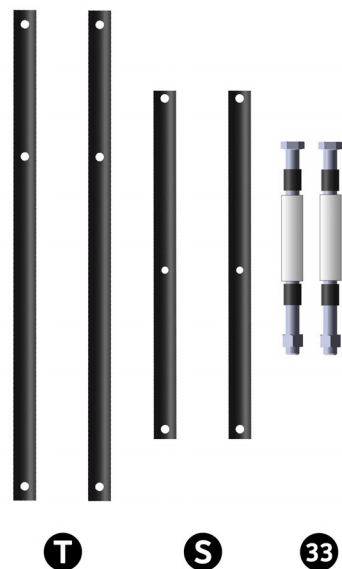



# INSTALLATION STEPS

## BACKBOARD

2.2

### Needed Parts

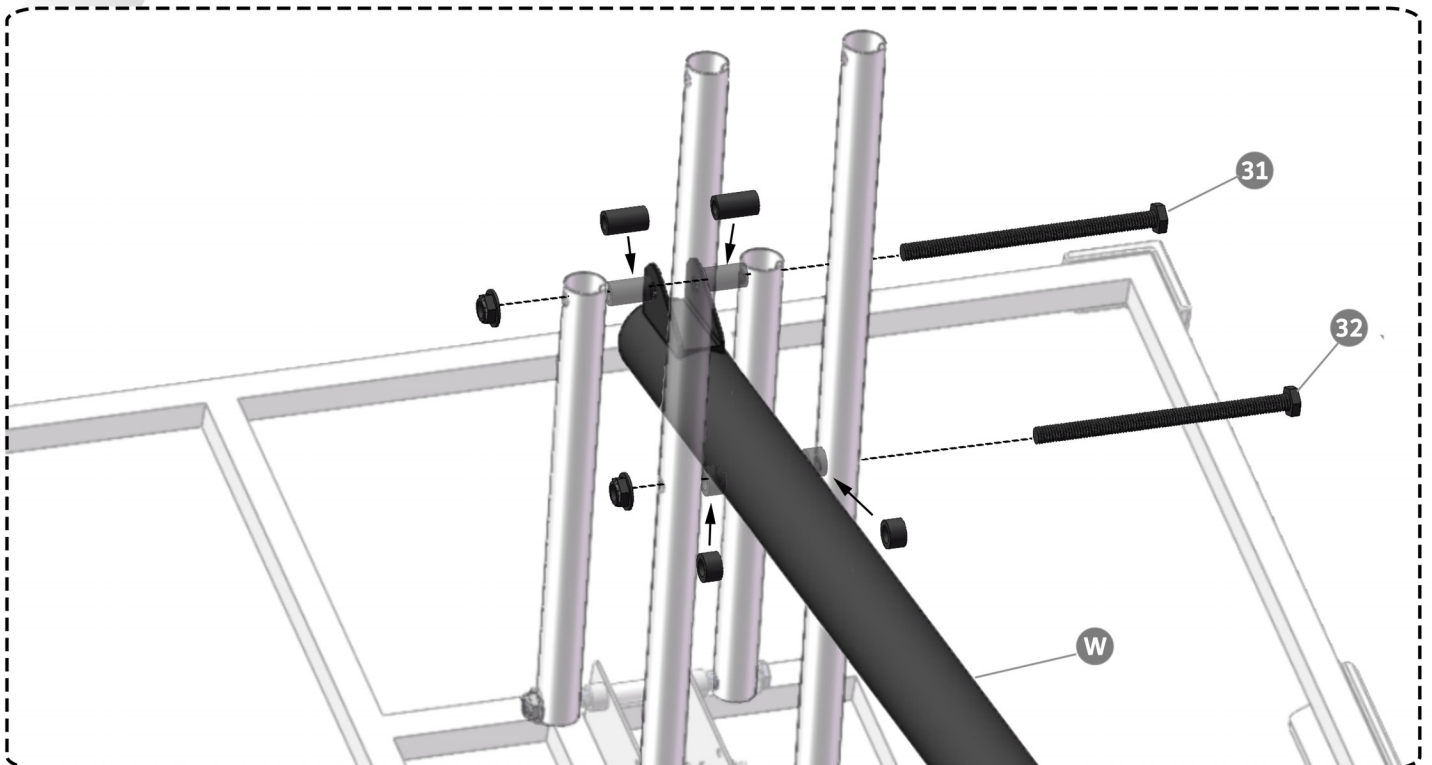
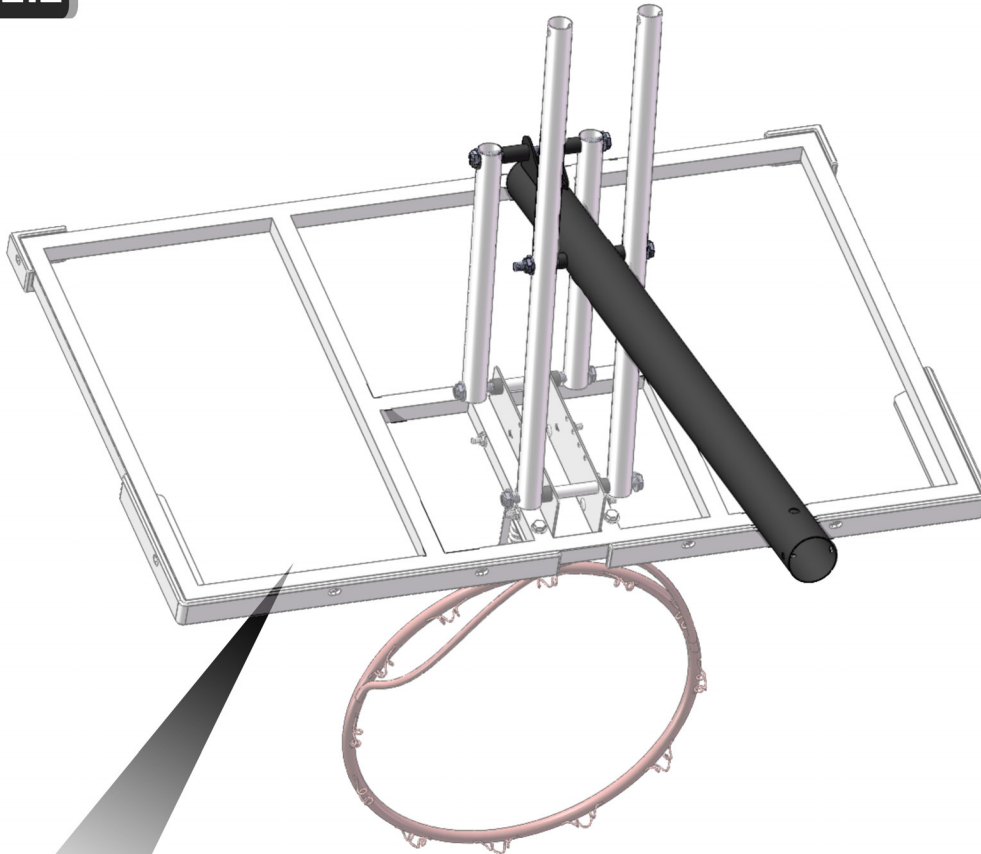
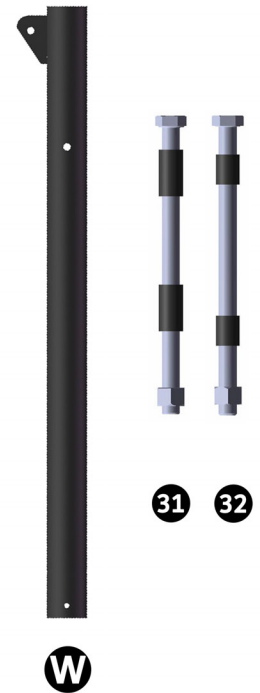



# INSTALLATION STEPS

## BACKBOARD

2.3

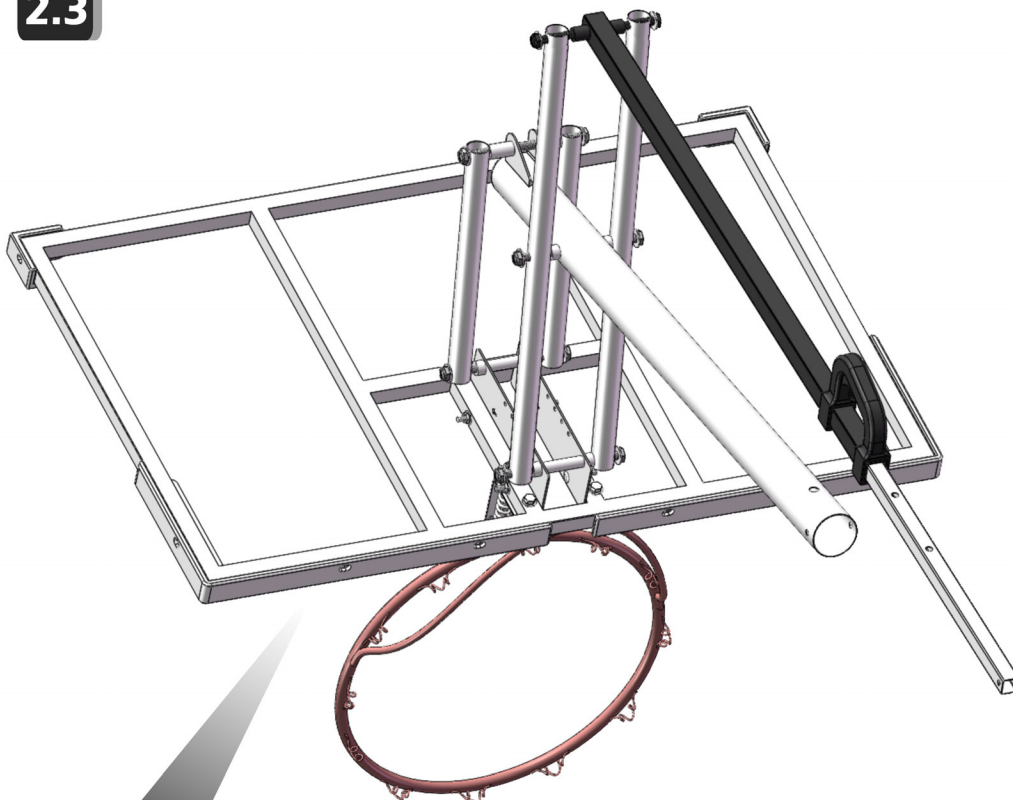

### Needed Parts



30



29



# INSTALLATION STEPS

## BACKBOARD

2.4

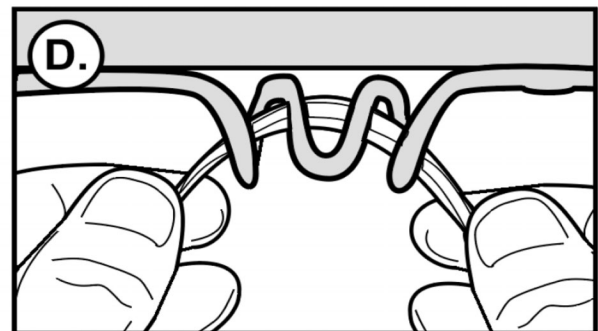
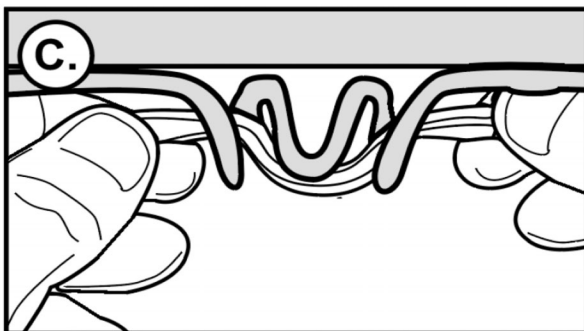
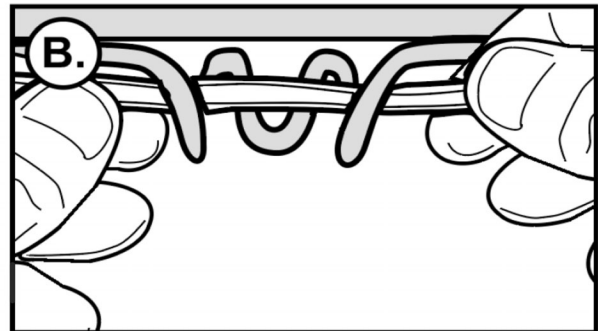
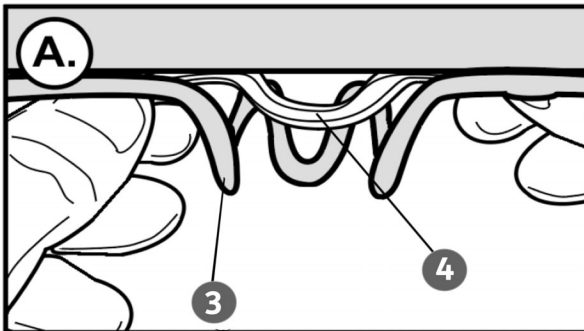
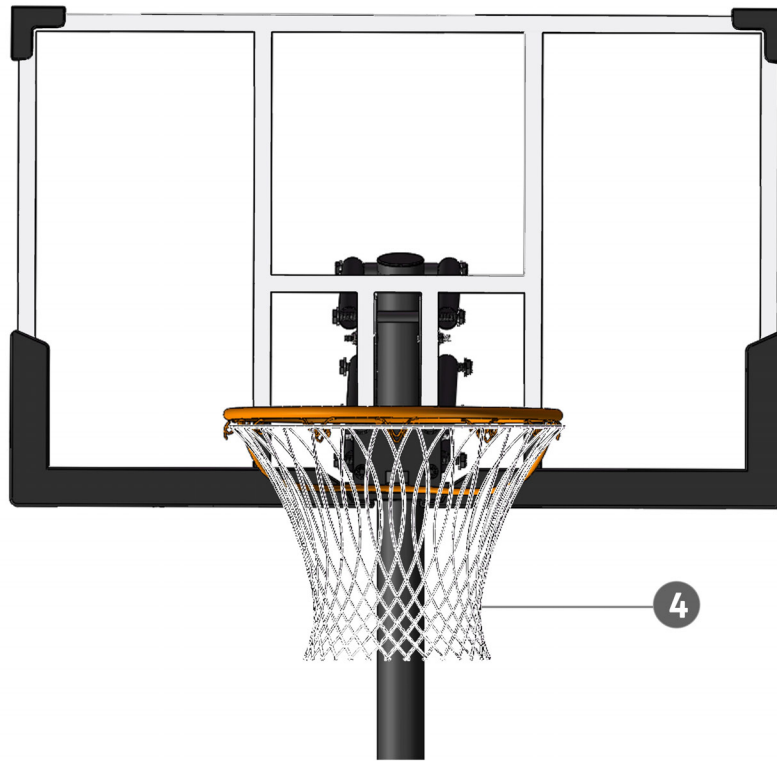

**The basketball hoop has a variety of installation methods**

1. If you need a height of 4.9FT - 6.9FT , please skip to page 11 to continue the installation
2. If you need a height of 8FT - 10FT, please skip to page 15 to continue the installation

# INSTALLATION STEPS

## BASE

### Needed Parts



3.1



3.2

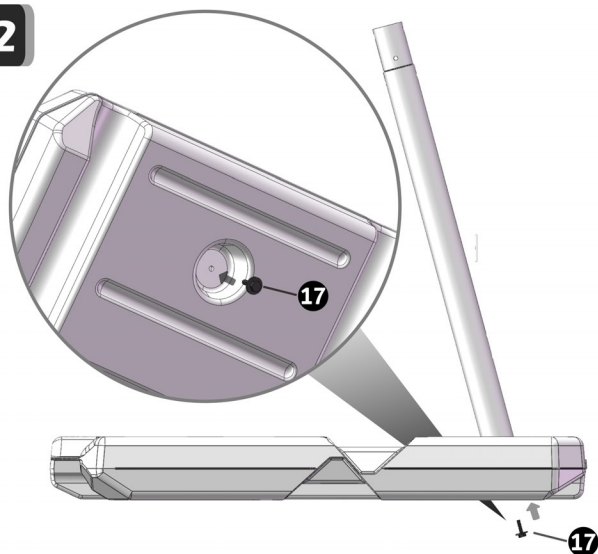

3.3

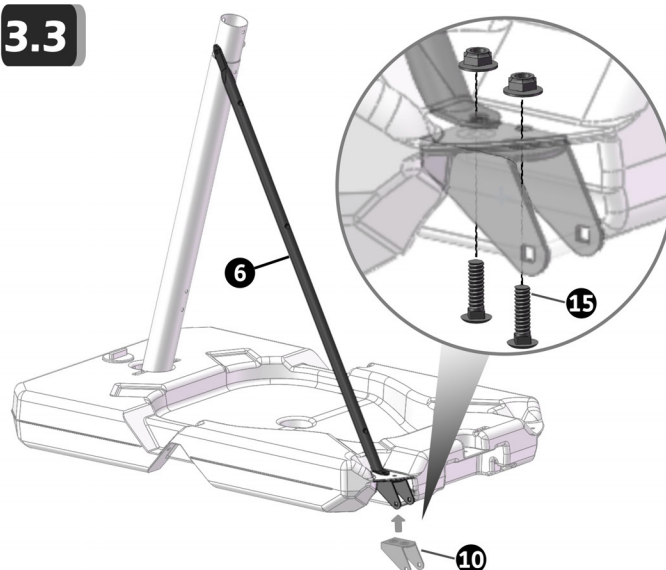

3.4

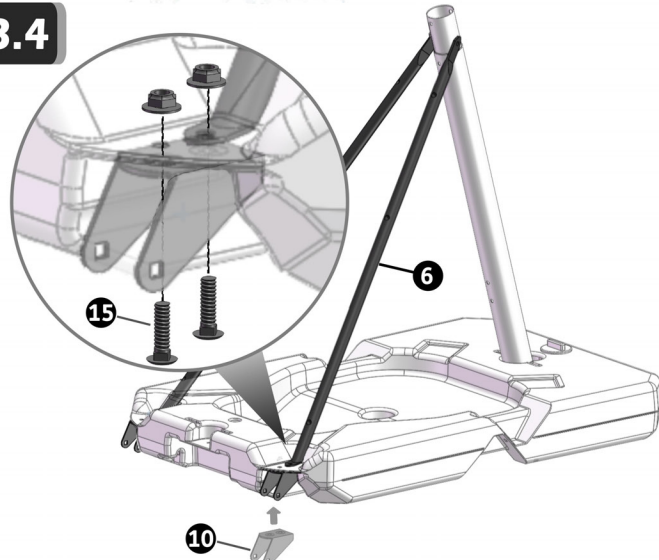

3.5

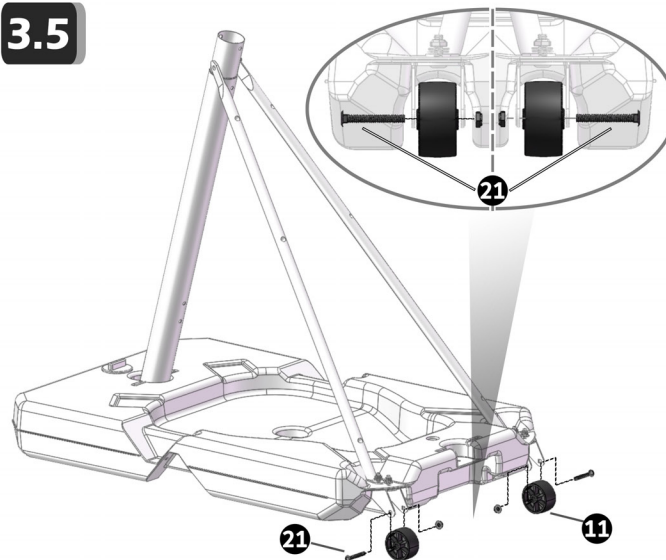

# INSTALLATION STEPS

## FINAL INSTALLATION

4.1

### 2 POLE MODE 4.9FT-6.9FT

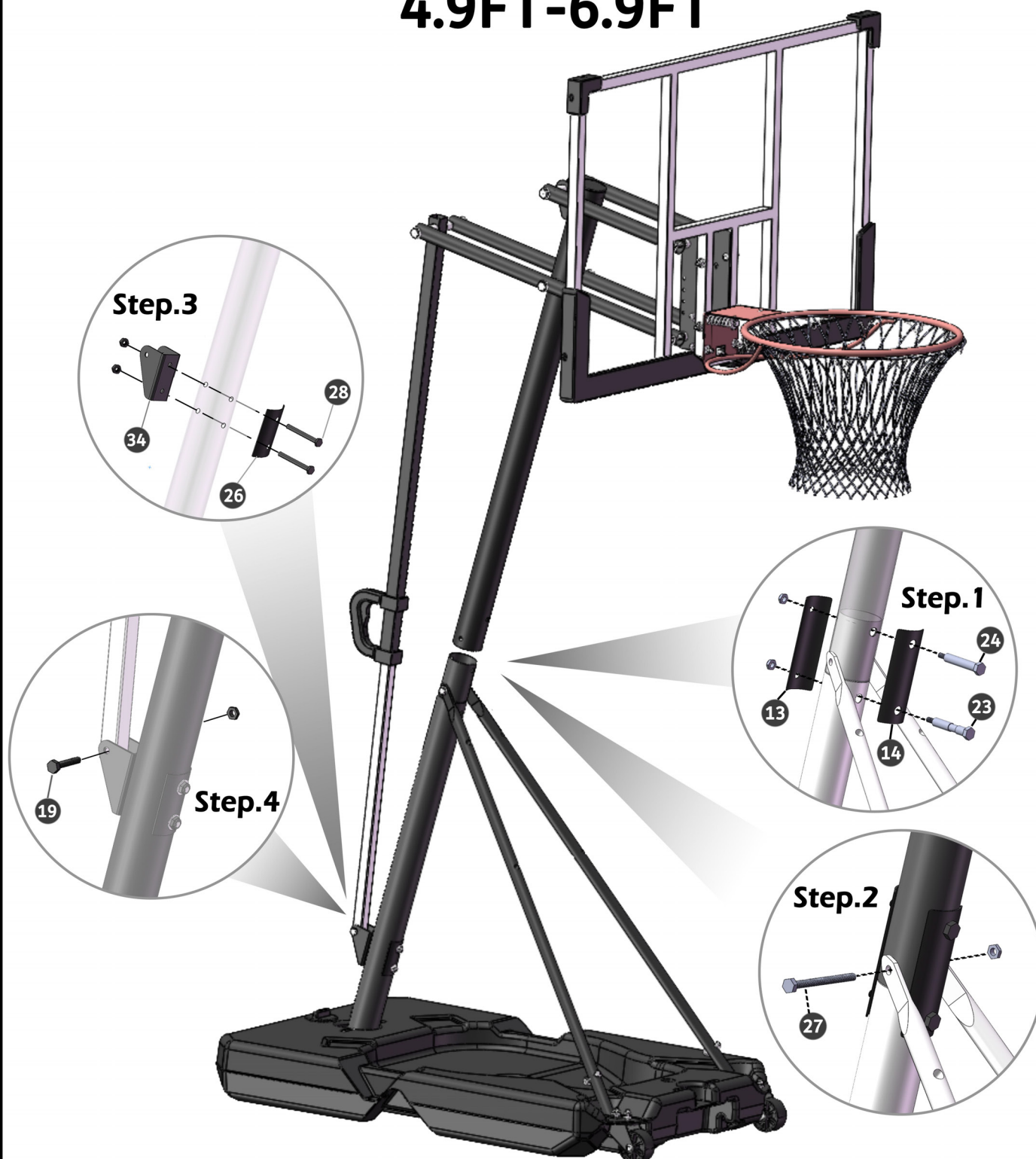



# INSTALLATION STEPS

## FINAL INSTALLATION

4.2

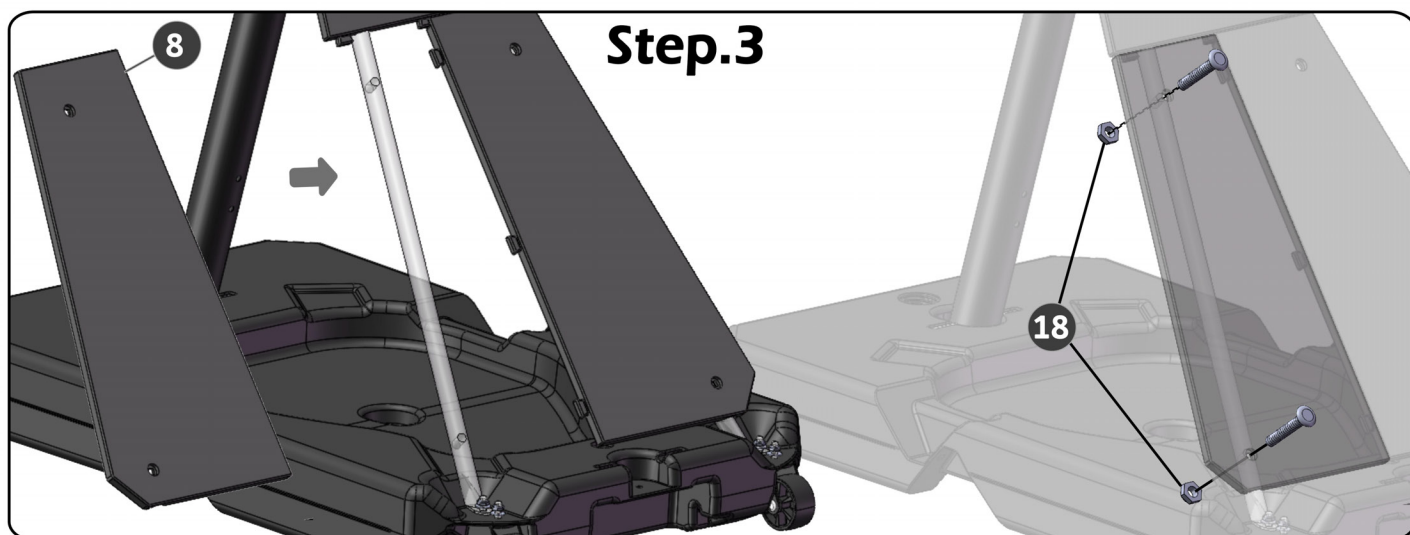
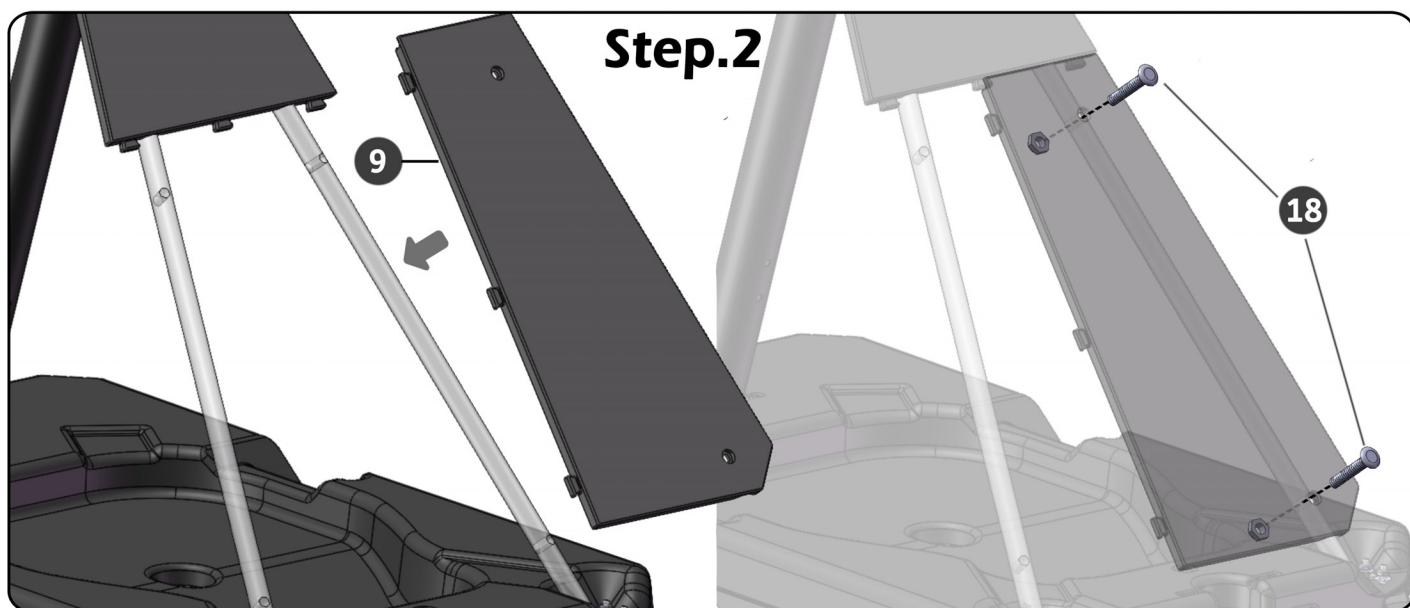
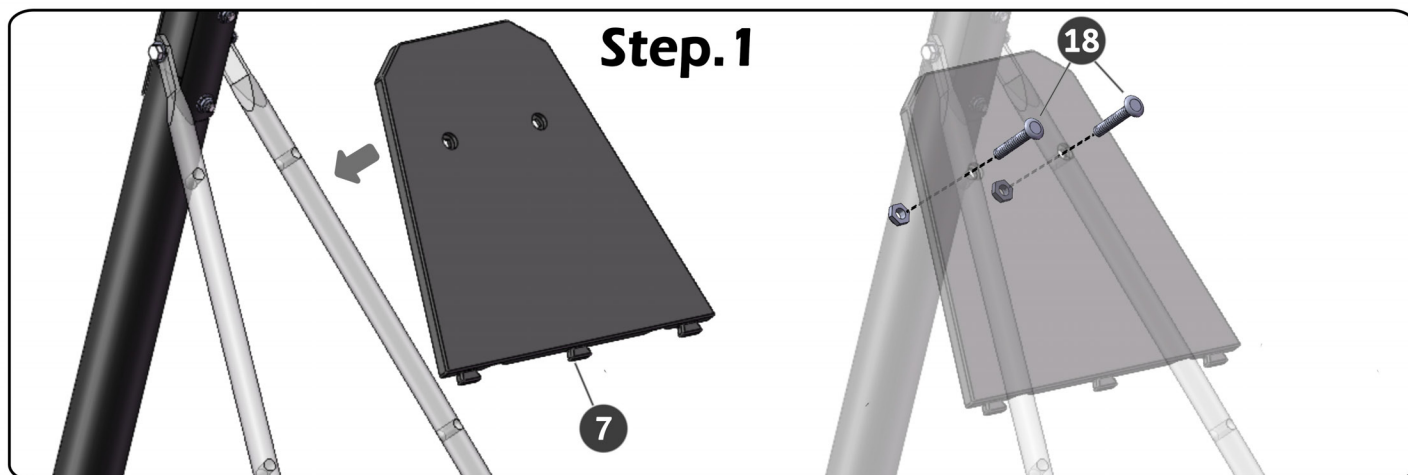



# INSTALLATION STEPS

## FINAL INSTALLATION

**4.3**

### 2 POLE MODE 4.9FT-6.9FT



FT	CM
4.9FT	150CM
5.4FT	165CM
5.9FT	180CM
6.4FT	195CM
6.9FT	210CM

#### ATTENTION:

Fill the base with water and place a 50 lbs weight on the base before using the basketball hoop.  
Or put 150 lbs on the base (no water needed).

# INSTALLATION STEPS

## BASE

### Needed Parts



5.1



5.2

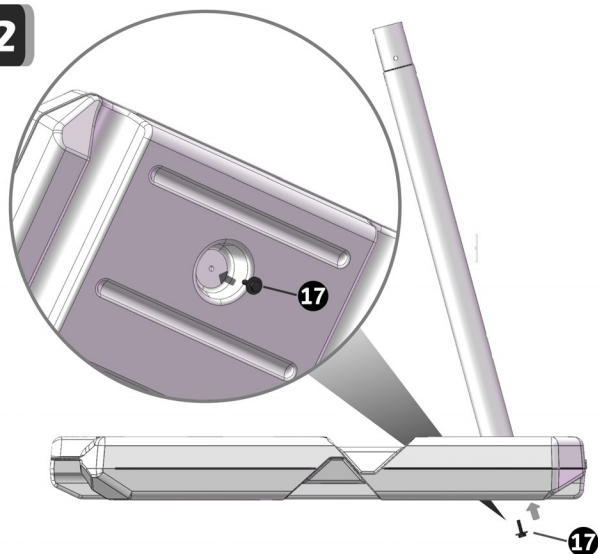

5.3

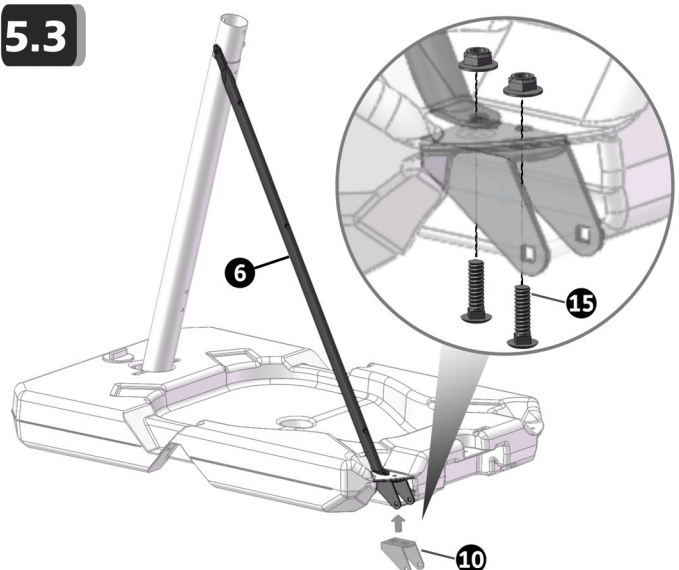

5.4

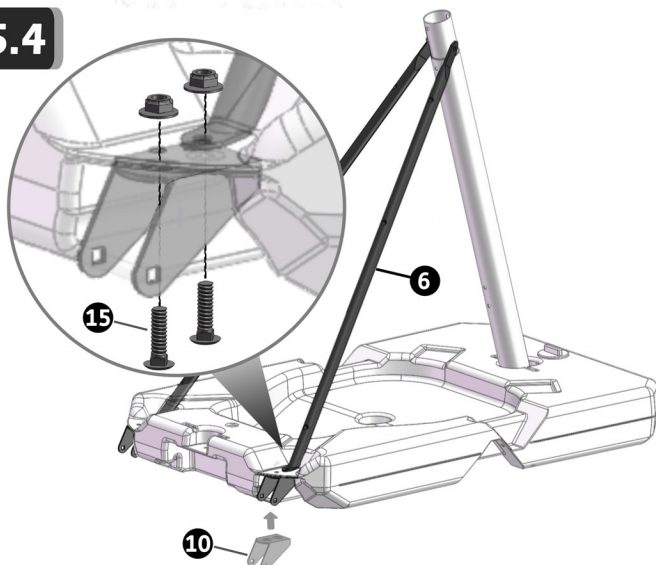

5.5

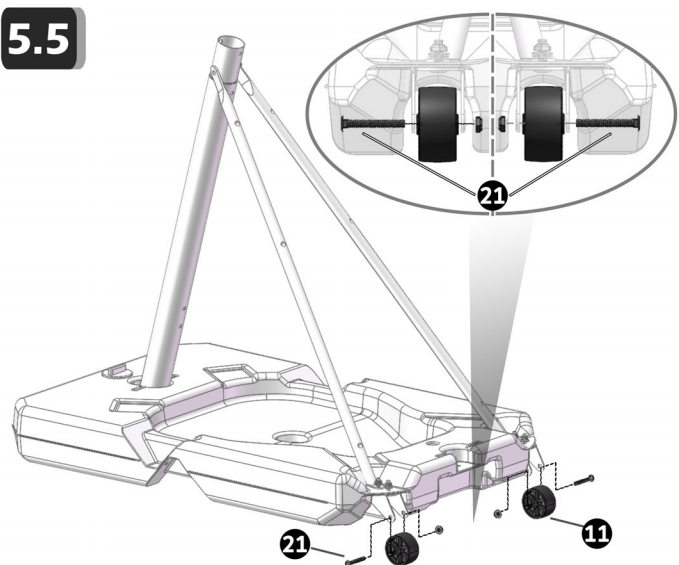

# INSTALLATION STEPS

## FINAL INSTALLATION

6.1

### 3 POLE MODE 8FT-10FT

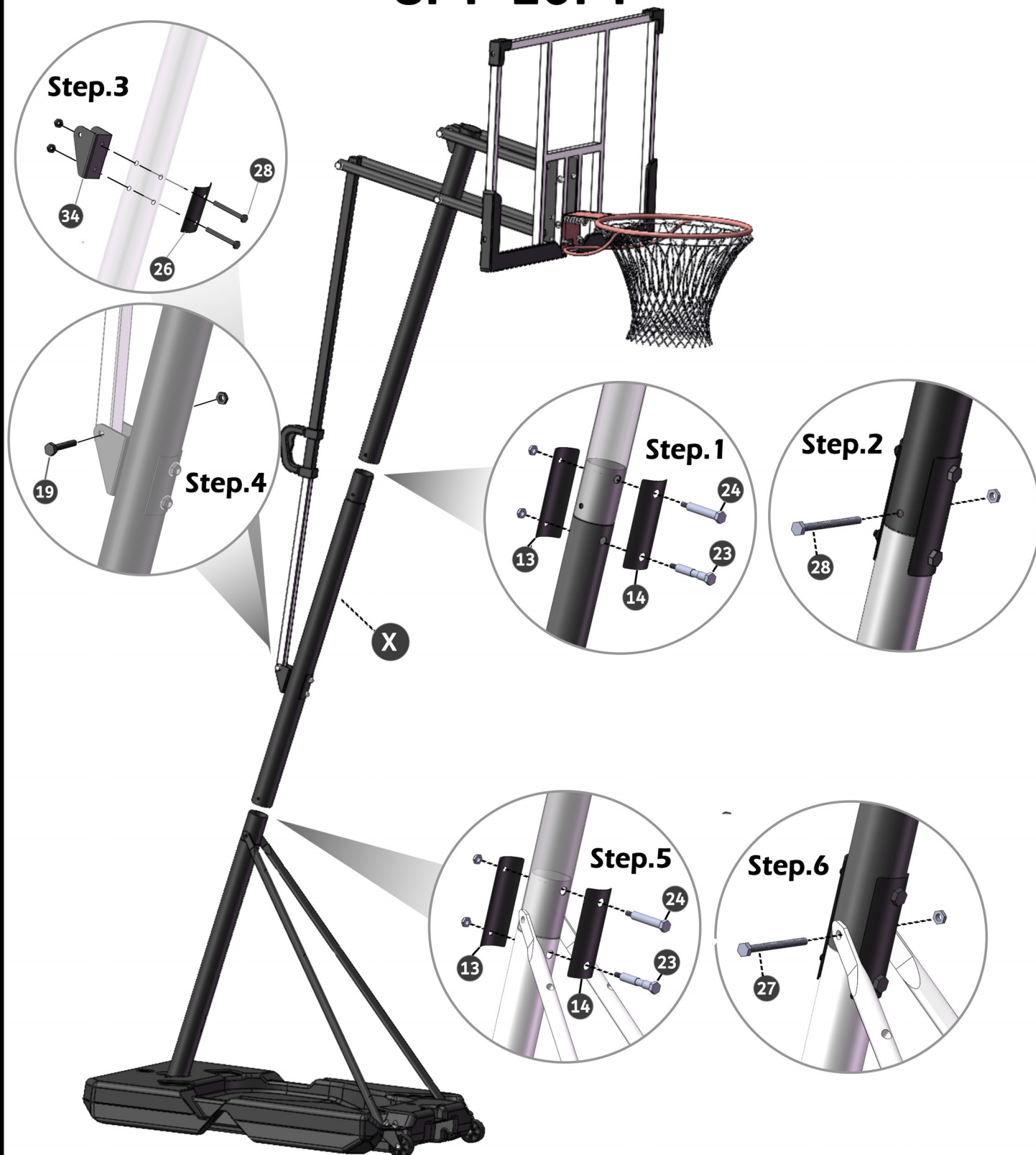



# INSTALLATION STEPS

## FINAL INSTALLATION

6.2

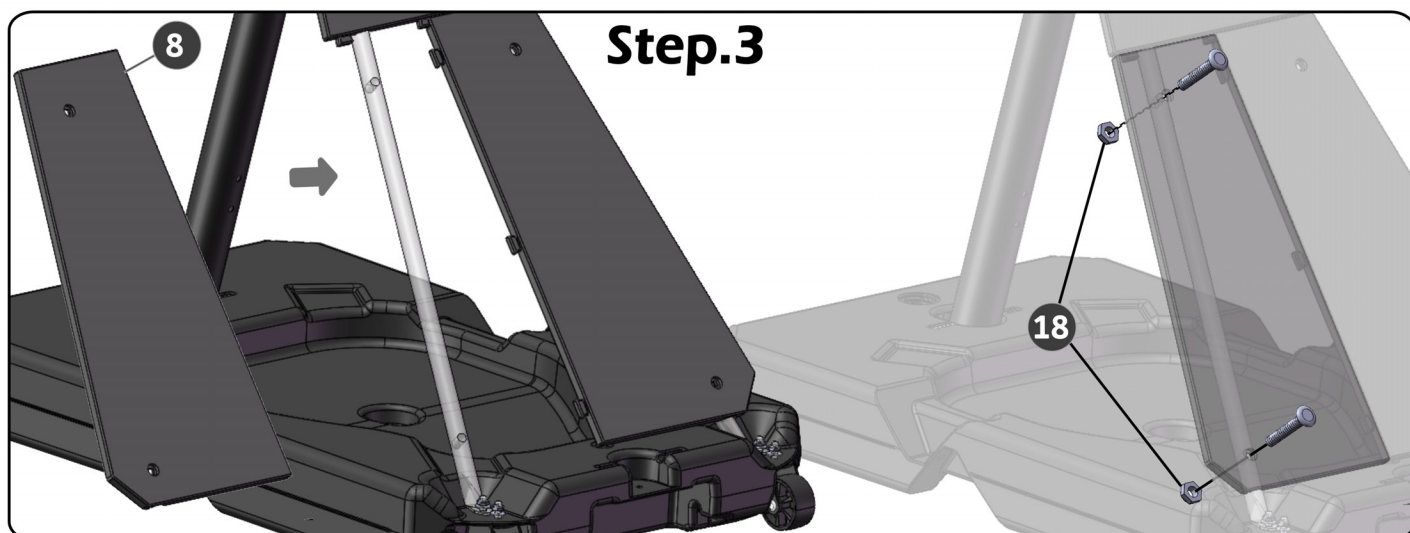
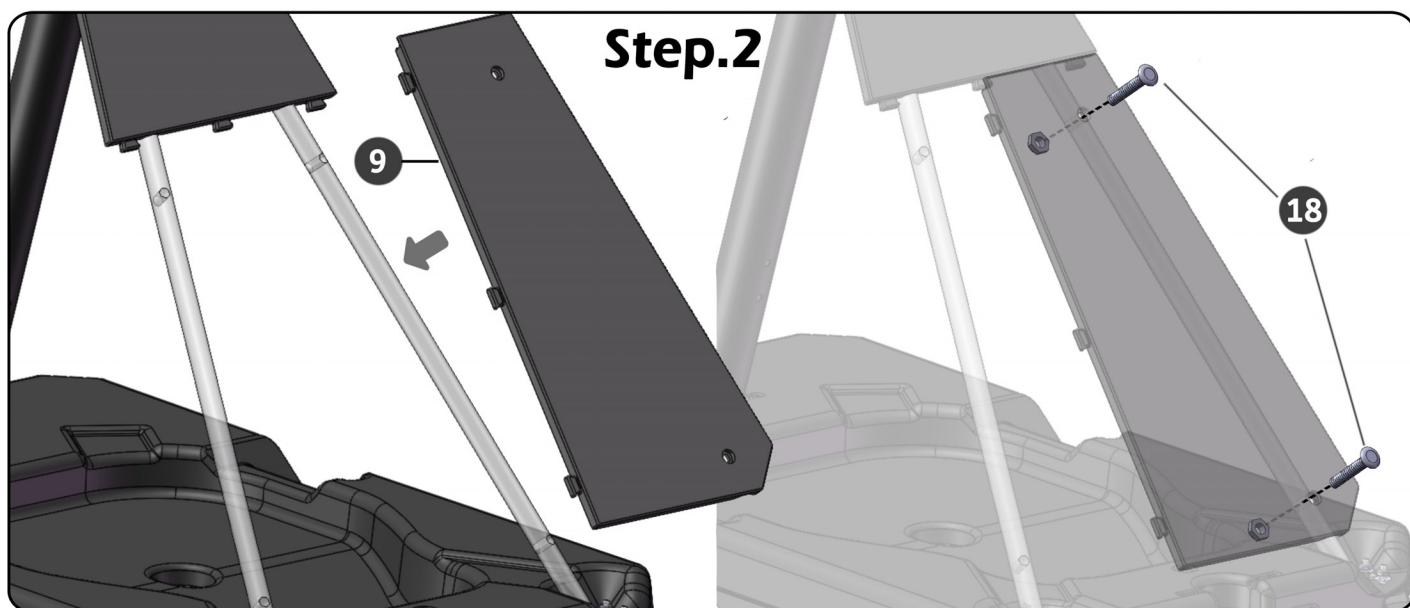
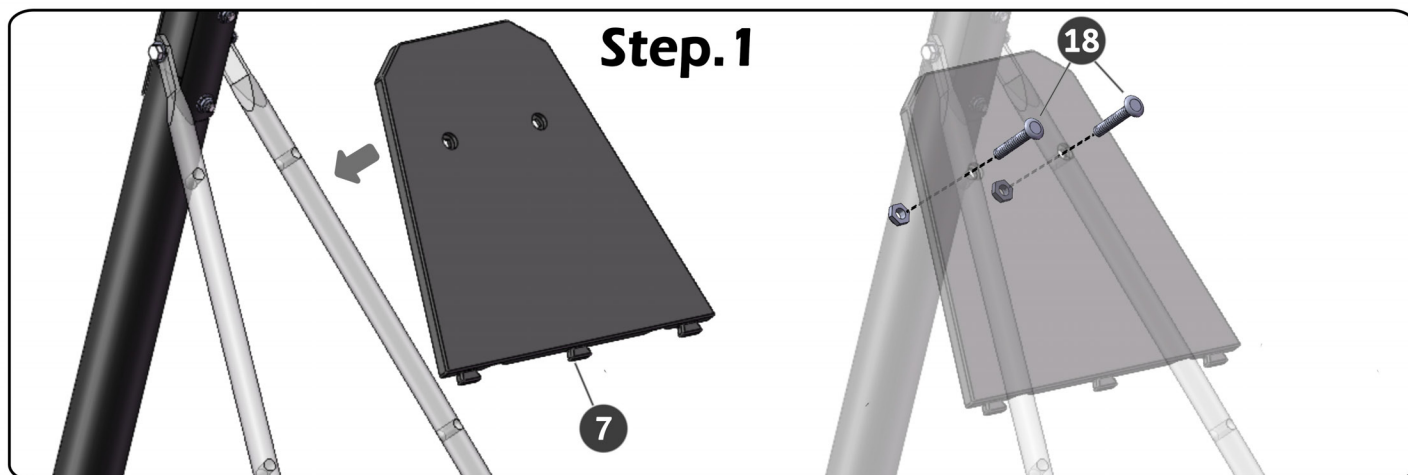

# INSTALLATION STEPS

## FINAL INSTALLATION

**6.3**

### 3 POLE MODE 8FT-10FT



FT	CM
8FT	245CM
8.5FT	260CM
9FT	275CM
9.5FT	290CM
10FT	305CM

**ATTENTION:**

Fill the base with water and place a 50 lbs weight on the base before using the basketball hoop.  
Or put 150 lbs on the base (no water needed).



**ELDICO**<sup>™</sup>  
sport



in conformity with the  
alternative packing  
management system

Distributed by **ELDICO SPORT SA**

eMail: [support@eldico.gr](mailto:support@eldico.gr) • Web Site: [eldico.gr](http://eldico.gr)